

fomaco

Introducing the FGM 26SC M2 injector



Centrifugal pump accessible for easy, hygienic cleaning & Inline filter on the pressure side of the pump to prevent clogged needles



For sanitation - conveyor belt easily removed without using tools. Conveyor frame has a quick-release system for easy, hygienic cleaning.



PLC for setting of pump pressure & speed. Constant read-out of current brine temperature.

fomaco

Created with passion, made for success

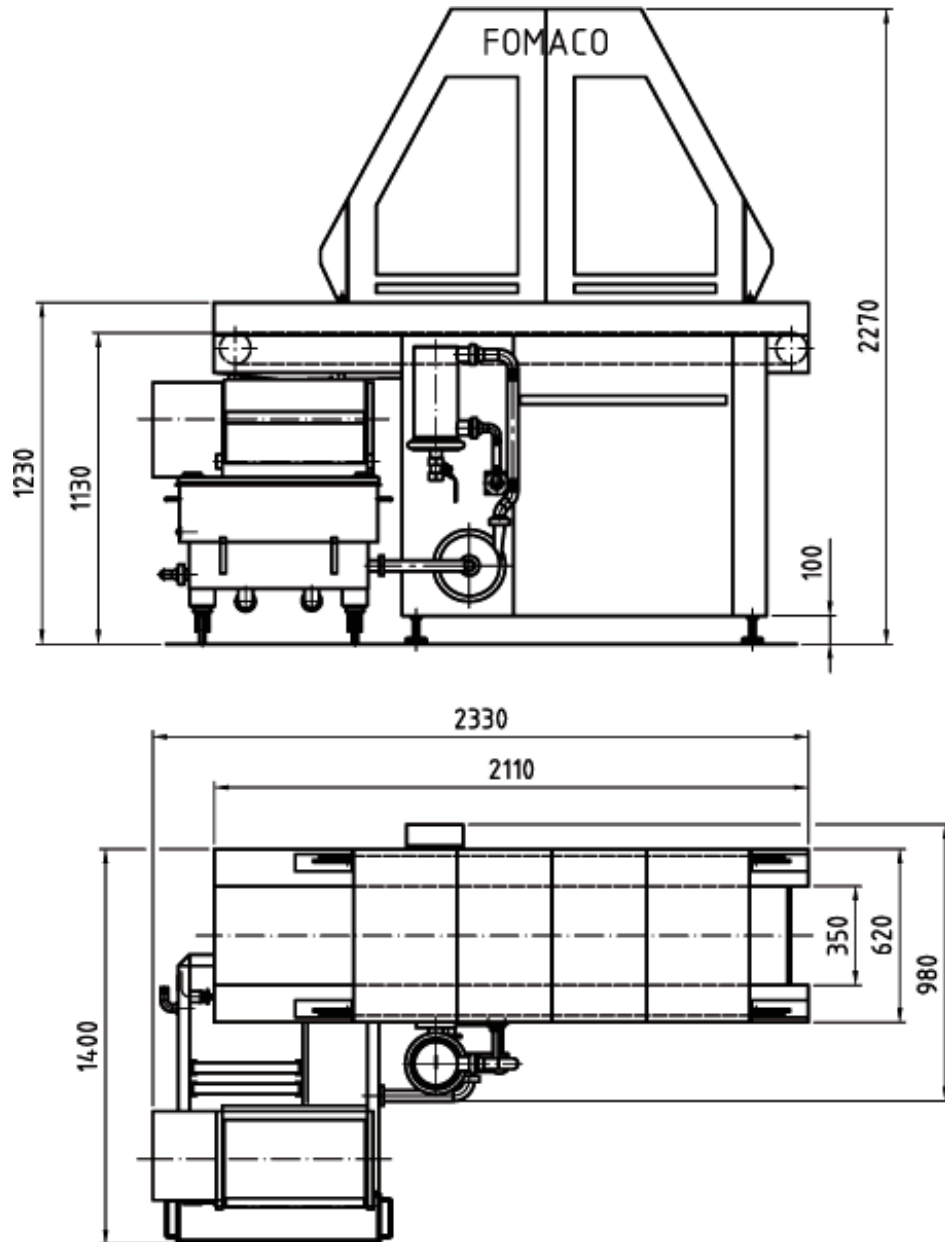

Specifications	
Motor	2,2 kW
Pump	Centrifugal Inoxpa
Pump motor	5,5 kW
Transport system	Conveyor belt - stainless steel or polyethylene
Width of transport system	350 mm
Product movement	30 mm or 50 mm per stroke of needle head
Speed of needle head	20-90 strokes per min
Number of needles	26 single, double or quadro needles
Max stroke height	230 mm
Max product height	200 mm



fomaco
 Food Machinery Company A/S
 Sandvadsvej 9
 DK-4600 Køge · Denmark

Phone: +45 56 63 20 00
 Fax: +45 56 63 20 30

www: fomaco.com
 E-mail: sales@fomaco.com

- Frequency converter for controlling the speed of the needle head is IP 66 waterproof.
- Frequency converter for pump is integrated on the pump motor.
- All other electrical components in stainless steel cabinet which is IP 68 waterproof.