

TOOLING SIZE IS A 240mm/MACHINE INDEX IS A 245mm TO ALLOW FOR ZIG ZAG CUT

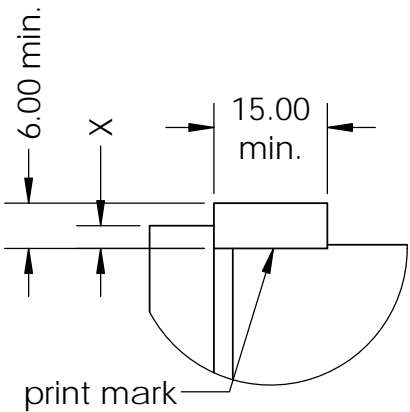
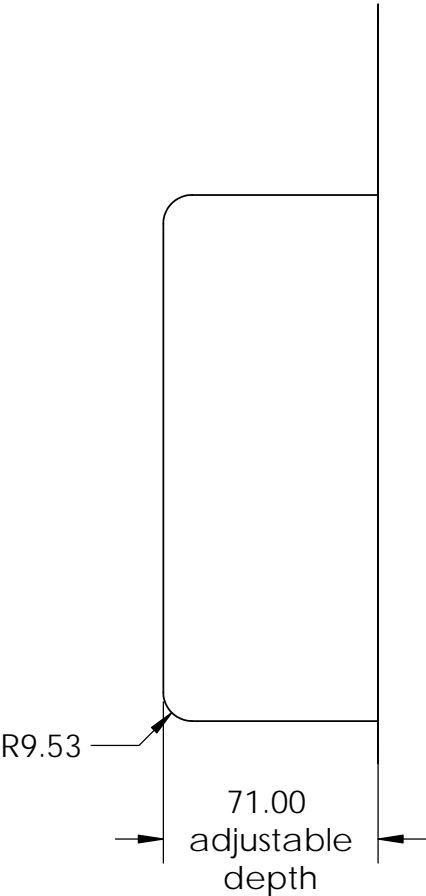
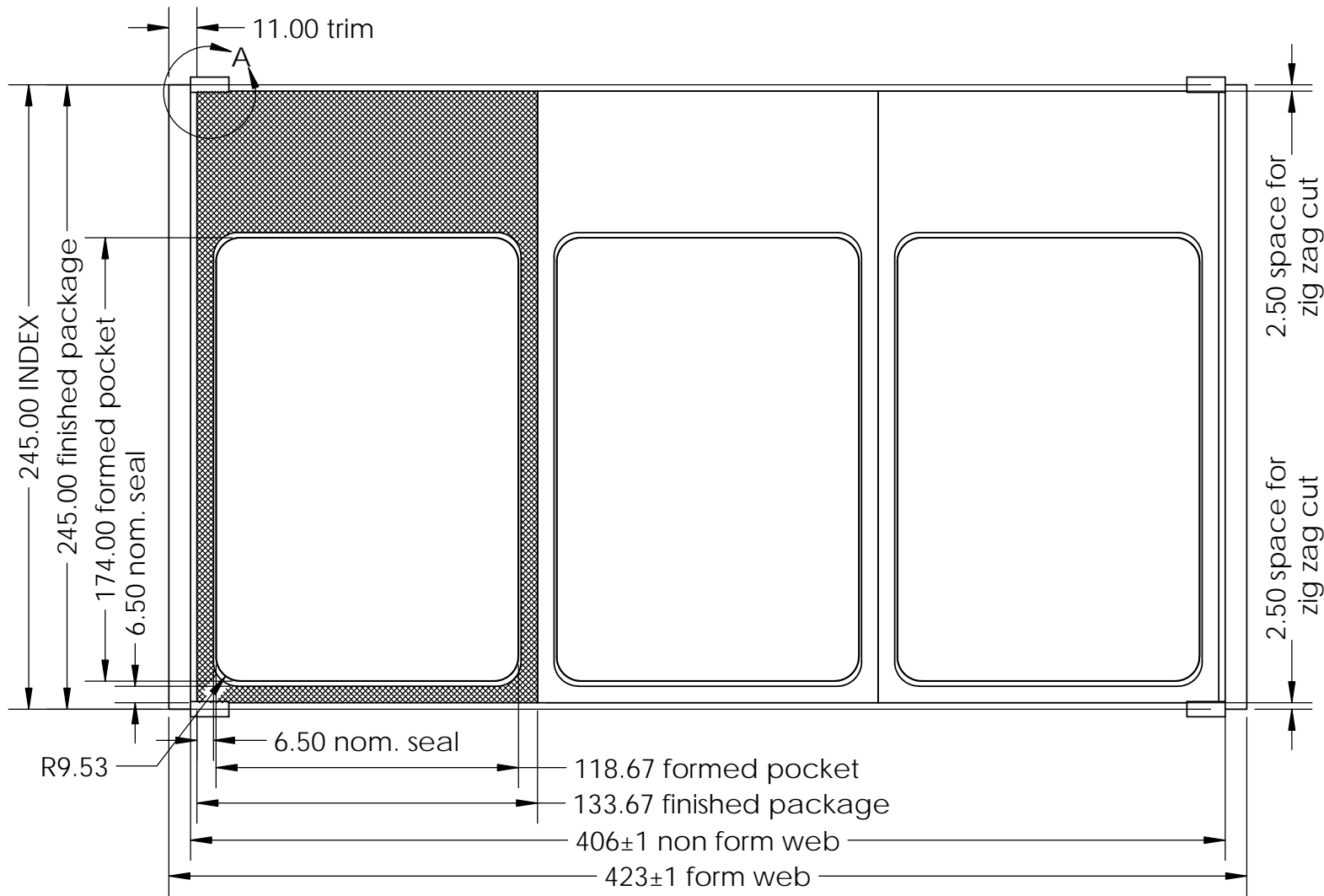
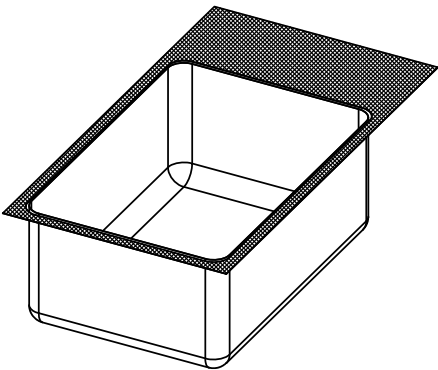

DETAIL A
SCALE 1 : 1

<div>MACHINE</div> <div>DIRECTION</div>	NOTES: (X)=Print Mark Tolerances, see VC999 doc. #11.27.73, MAX TOOL DEPTH, 100die=75.88 (1:1=85.41)/ 135die=114.6 (1:1=124.15)										
	APPROVAL FOR PRODUCTION			DESCRIPTION layout 420.240.245.100.3.1.hdr.		File Name 420.240.245.100.3.1.hdr.zz					
	APPROVED:			THIS PRINT CONTAINS CONFIDENTIAL INFORMATION WHICH IS THE PROPERTY OF VC999. BY ACCEPTING THIS INFORMATION THE BORROWER AGREES THAT IT WILL NOT BE USED FOR ANY PURPOSE OTHER THAN THAT FOR WHICH IT IS LOANED.		DATE (M-D-Y) 9/30/2022		Drawn by J.Romfo			
	DATE:					Designer		Checked by JGR			
	APPROVED WITH NOTED CHANGES:			This is an Electronically Generated Document, DO NOT SCALE		<div><div><div></div><div>VC999®</div></div><div>419 East 11th Avenue Kansas City, MO 64116 Telephone 816-472-8999 Fax 816-472-1999</div><div>Packaging Systems, Inc.</div></div>					
	DATE:			SHEET SIZE B						SCALE 1:2.5	